

SECTION 6

Panasonic Broadcast AW-PH405 Mechanical Parts

Note:

1. *Be sure to make your orders of replacement parts according to this list.
2. Unless otherwise specified, all resistors are in OHMS, K=1,000 OHMS, all capacitors are in MICROFARADS (μF), P= $\mu\mu\text{F}$,
3. The P.C.Board unit marked with "■" shown below the main assembled parts.
4. The parts marked with $\text{\textcircled{E}}$ on the exploded view show the electric parts.
5. IMPORTANT SAFETY NOTICE
Components identified with the mark \triangle have the special characteristics for safety. When replacing any of these components, use only the same type.
6. The marking (RTL) indicates the retention time is limited for this item.
After the discontinuation of this assembly in production, it will no longer be available.
7. "M" in Remark column indicates needed in the periodical maintenance.

CONTENTS

CHASSIS FRAME ASSEMBLY	PRT-1
PACKAGING PARTS ASSEMBLY	PRT-3

Ref. No.	Part No.	Part Name & Description	Pcs	Remarks
1	P40B0D01P001	UPPER CHASSIS	1	
2	P45B0D01P002	BASE	1	
3	P40B0D01P010	BASE OPTION PANEL	1	
4	P45B0D01MK51	D-SUB CONNECTER PANEL ASS'Y	1	
5	P45B0D01MK01	HOUSING CASE UNIT	1	
5-1	P45B0D01MK52	HOUSING CASE ASS'Y	1	
5-2	P45B0D01MK53	TALLY LAMP ASS'Y	1	
5-3	P40B0D01P006	TALLY BLANK PANEL	1	
6	P45B0D01MK02	BOARD COVER UNIT	1	
6-1	P45B0D01MK54	COVER ASS'Y	1	
7	P45B0D01MK03	UPPER CONNECTER PANEL UNIT	1	
7-1	P45B0D01MK55	UPPER CONNECTER PANEL ASS'Y	1	
8	P45B0D01MK04	BASE CONNECTOR PANEL UNIT	1	
8-1	P45B0D01MK56	BASE CONNECTOR PANEL ASS'Y	1	
8-2	P45B0D01MK57	BASE STOPPER ASS'Y	1	
9	P45CMA01MK01	CAMERA ARM UNIT	1	
9-1	P45CMA01MK51	ARM ASS'Y	1	
9-2	P45CMA01MK52	CAMERA BASE ASS'Y	1	
9-3	P45CMA01MK53	CAMERA SCREW ASS'Y	1	
10	P45GYU01MK51	GEAR CASE ASS'Y	2	
11	P45GYU01MK52	PAN GEAR BOX ASS'Y	1	
12	P45GYU01MK53	TILT GEAR BOX ASS'Y	1	
13	P45GYU01MK54	GEAR BOX MOTOR ASS'Y	2	
14	P45GYU01MK55	GEAR BOX POTENTIO ASS'Y	2	
15	P45GYU01B108	GT BELT	2	
16	P45DAC01MK01	AC ADAPTER UNIT	1	AW-PH405N
	P45DAC01MK02	AC ADAPTER UNIT	1	AW-PH405E
	P45DAC01MK03	AC ADAPTER UNIT	1	AW-PH405MC
16-1	P45DAC01MK51	DC FILTER BOARD ASS'Y	1	
16-2	P45DAC01MK52	POWER RECTIFIER ASS'Y	1	
16-3	P45DAC01MK53	ADAPTER COVER ASS'Y	1	AW-PH405N
	P45DAC01MK54	ADAPTER COVER ASS'Y	1	AW-PH405E
	P45DAC01MK55	ADAPTER COVER ASS'Y	1	AW-PH405MC
17	J0KG00000012	FERRITE CORE	5	
18	J0KG00000011	FERRITE CORE	1	
E1	VJBB0451	CPU P.C.BOARD	1	(RTL)
E2	VJBB0452	DRIVER P.C.BOARD	1	(RTL)
E3	VJBB0500	COMP P.C. BOARD	1	(RTL)
E4	VJBB0501	CONNECTOR P.C.BOARD	1	(RTL)
E5	VJBB0502	DC/DC P.C.BOARD	1	(RTL)
E6	VJBB0503	DC FILTER P.C.BOARD	1	(RTL)
E7	VJBB0453	FILTER P.C.BOARD	1	(RTL)
E8	VJBB0522	AC/DC FILTER P.C.BOARD	1	(RTL)
101	P45HAS01P001	CAMERA I/F CABLE	1	
102	P45HAS01P002	LENS RD CABLE	1	
103	P45HAS01P003	LENS I/F CABLE	1	
104	P45HAS01P004	ND/EXT CABLE	1	
105	P45HAS01P005	SDI CABLE	1	
106	P45HAS01P006	AUX CABLE	1	
107	P45HAS01P008	TALLY SW CABLE	1	
108	P45HAS01P010	MOTOR CONTROL CABLE	1	
109	P45HAS01P011	P/T CONTROLLER CABLE	1	
110	P45HAS01P012	CPU POWER CABLE	1	
111	P45HAS01P013	DRIVER POWER CABLE	1	
112	P45HAS01P014	CN POWER CABLE	1	
113	P45HAS01P015	POWER CABLE	1	
114	P45HAS01P016	COMP POWER CABLE	1	
115	P45HAS01P017	FG1 CABLE	1	
116	P45HAS01P018	FG2 CABLE	1	
117	P45HAS01P019	THERMISTOR CABLE	1	
118	P45HAS01P023	LENS P/S CABLE	1	

Ref. No.	Part No.	Part Name & Description	Pcs	Remarks
		AW-PH405N		
201	VGNB0154	MAIN LABEL	1	
202	V7MA0270A4	FUSE REPLACE LABEL	2	
203	VQLB0227	SWITCH LABEL	1	
204	A7SA0689A4	EARTH MARK LABEL	1	
205	V7MA0099B4	SCREW CAUTION LABEL	2	
206	V7MA0338A4	SEE MANUAL LABEL	2	
207	VQLB0090	EARTH CAUTION LABEL	1	
208	VQLB0077	SETTING LABEL	1	
209	V7MA0106A4	CAUTION LABEL	1	
210	V7MA1006A4	PL CAUTION LABEL	1	
213	VQL0L14	SERIAL NUMBER LABEL	1	
		AW-PH405E		
201	VGNB0155	MAIN LABEL	1	
202	V7MA0270A4	FUSE REPLACE LABEL	2	
203	VQLB0227	SWITCH LABEL	1	
204	A7SA0689A4	EARTH MARK LABEL	1	
205	V7MA0099B4	SCREW CAUTION LABEL	1	
206	V7MA0338A4	SEE MANUAL LABEL	2	
208	VQLB0077	SETTING LABEL	1	
213	VQL0L14	SERIAL NUMBER LABEL	1	
		AW-PH405MC		
201	VGNB0156	MAIN LABEL	1	
202	VQLB0075	FUSE REPLACE LABEL	2	
204	A7SA0689A4	EARTH MARK LABEL	1	
205	3PC001356AAA	SCREW CAUTION LABEL	1	
206	3PC001361AAA	SEE-MANUAL LABEL	2	
208	VQLB0078	SETTING LABEL	1	
211	VQLB0071	PRODUCT LABEL	3	
212	3PD003493AAA	EPUP MARK LABEL	1	
213	VQL0L14	SERIAL NUMBER LABEL	1	

PACKAGING PARTS ASSEMBLY (For AW-PH405N/E)

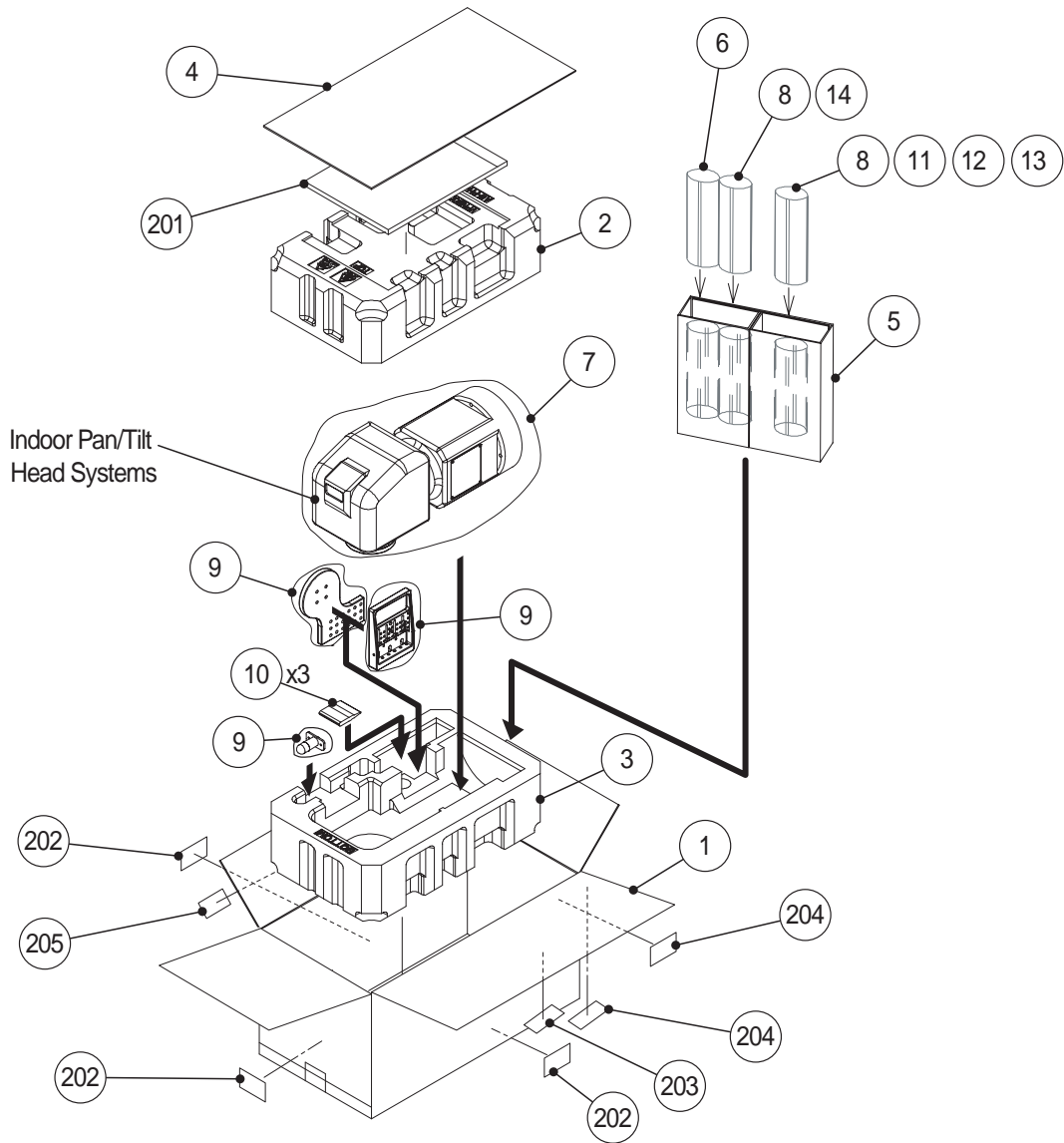

Ref. No.	Part No.	Part Name & Description	Pcs	Remarks
1	VPGB0023	PACKAGING CASE	1	
2	VPNB0028-1	CUSHION(TOP)	1	
3	VPNB0027-1	CUSHION(BOTTOM)	1	
4	VPNB0030	TOP PAD	1	
5	VPNB0029	CORD PAD	1	
6	VEEB0084	CAMERA CABLE	1	
7	PE45X63C05B	BAG(UNIT)	1	
8	PE20X35C05B	BAG(CABLE)	2	N:1Pcs
9	YWY15X20C03	BAG(ARM,CAMERA BASE,TALLY)	3	
10	YWT10X10C03	BAG(ACCESSORIES)	3	
10-1	VMWB0001	WIRE	1	
	VHDB0019	SCREW	1	
	XWE6FN	WASHER	1	
	P45PAC01B015	SPRING WASHER	1	
	XYN4+F8FN	SCREW	2	
10-2	TWH-15	WRENCH(M5)	1	
	P40PAC01B024	CAP SCREW	7	
10-3	P40B0D01P006	TALLY BLANK PANEL	1	
	XSN3+6FN	SCREW	2	

Ref. No.	Part No.	Part Name & Description	Pcs	Remarks
		AW-PH405N		
11	KDK-UL-2	AC CABLE	1	
12	VQLB0081	CABEL TAG	1	
201	VQFB0061	PRINTED MATTERS BAG	1	
202	V8FA1173B4	PACKAGING LABEL	3	
203	V8FA0070A4	TOP LABEL	1	
204	VQL0L14	SERIAL NUMBER LABEL	2	
205	VQL8185	SEE MANUAL LABEL	1	
		AW-PH405E		
13	P45PAC01B011	AC CABLE(EUROPE)	1	
14	KDK-BS-2N	AC CABLE(U.K.)	1	
201	VQFB0062	PRINTED MATTERS BAG	1	
202	V8FA1314B4	PACKAGING LABEL	3	
203	V8FA0070A4	TOP LABEL	1	
204	VQL0L14	SERIAL NUMBER LABEL	1	

PACKAGING PARTS ASSEMBLY (For AW-PH405MC)

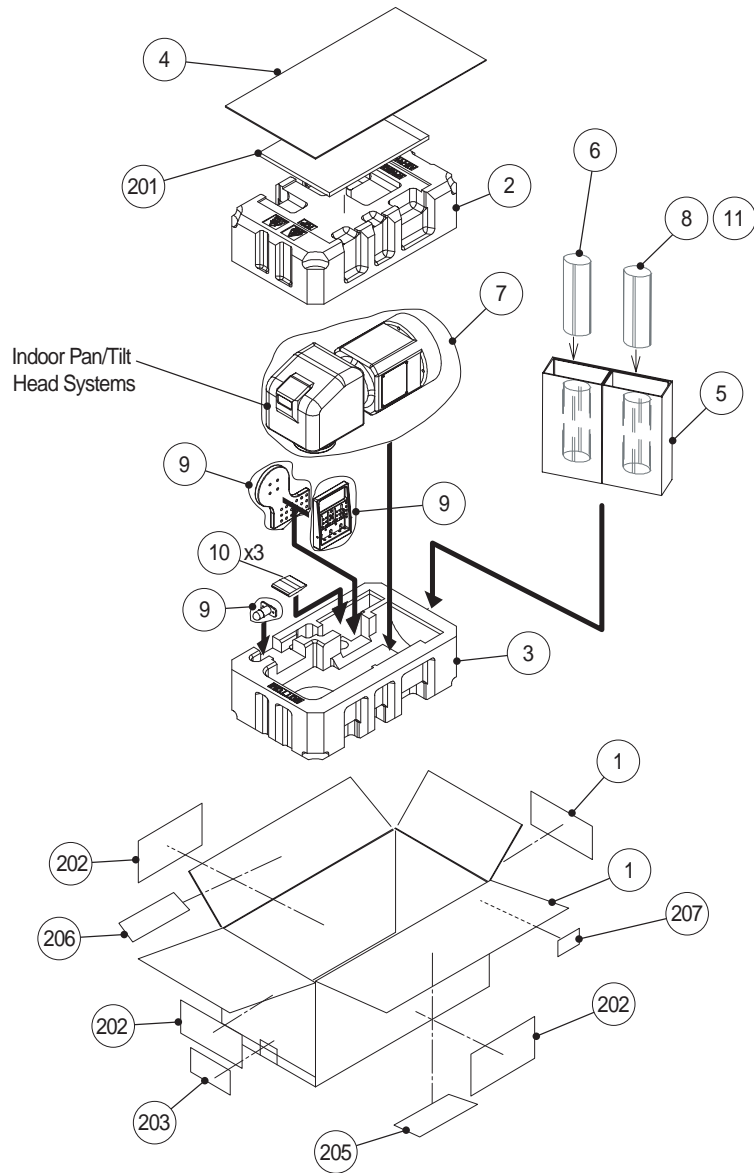

Ref. No.	Part No.	Part Name & Description	Pcs	Remarks
1	VPGB0023	PACKAGING CASE	1	
2	VPNB0028-1	CUSHION(TOP)	1	
3	VPNB0027-1	CUSHION(BOTTOM)	1	
4	VPNB0030	TOP PAD	1	
5	VPNB0029	CORD PAD	1	
6	VEEB0084	CAMERA CABLE	1	
7	PE45X63C05B	BAG(UNIT)	1	
8	PE20X35C05B	BAG(CABLE)	1	
9	YWY15X20C03	BAG(ARM,CAMERA BASE,TALLY)	3	
10	YWT10X10C03	BAG(ACCESSORIES)	3	
10-1	VMWB0001	WIRE	1	
	VHDB0019	SCREW	1	
	XWE6FN	WASHER	1	
	P45PAC01B015	SPRING WASHER	1	
	XYN4+F8FN	SCREW	2	
10-2	TWH-15	WRENCH(M5)	1	
	P40PAC01B024	CAP SCREW	7	
10-3	P40B0D01P006	TALLY BLANK PANEL	1	
	XSN3+6FN	SCREW	2	
11	K2CK3DH00019	AC CABLE	1	

Ref. No.	Part No.	Part Name & Description	Pcs	Remarks
201	VQFB0063	PRINTED MATTERS BAG	1	
202	V8FA1314B4	PACKAGING LABEL	3	
203	VQLB0009	ORIGIN LABEL	1	
204	VQL0X01	QUALITY LABEL	1	
205	VQLB0049	HANDLING LABEL	1	
206	VQLB0050	SEE-MANUAL LABEL	1	
207	VQL0L14	SERIAL NUMBER LABEL	1	